

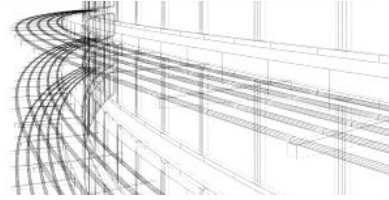

Stephen Napper  
Associates  
Limited

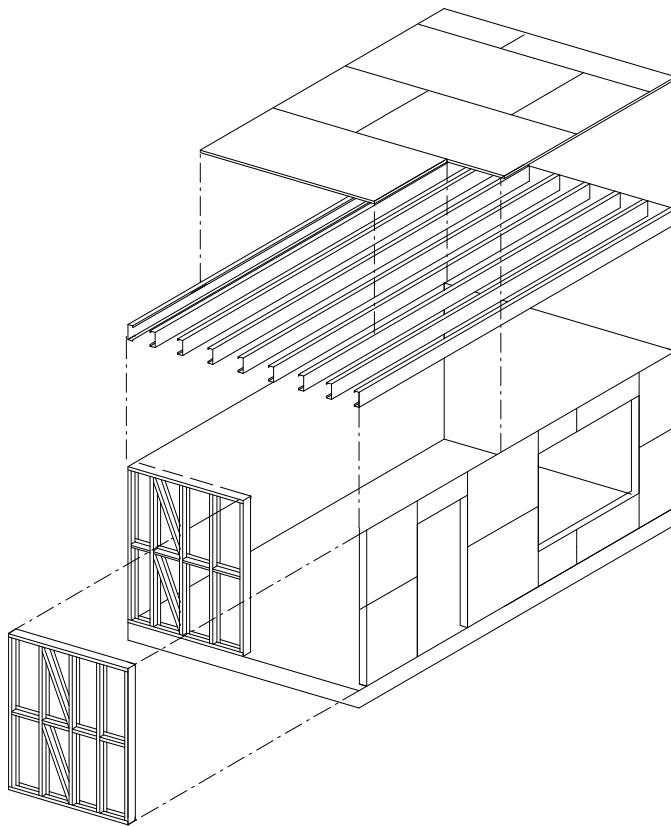

Stephen Napper Associates Limited, working with the Steel Construction Institute in association with BM Trada, is pleased to offer technical manuals suitable for CE Marking under the Construction Products Regulation. The practice offers a technical manual service with the SCI providing a technical assessment of the system and manual, leading to SCI Assessed status. For CE marking, notified body services are provided by BM Trada. Assessments may also be undertaken for Stage 1 NHBC, Lloyds/Buildoffsite and Q Mark.



The Technical Manual includes section properties, load capacity tables and standard construction details **all of which are assessed by SCI** for a wide range of applications. These include: wall frames, infill walls, floor joists, roof trusses and over cladding of existing buildings.

The Building Regulations are due to be updated in

April 2013, coming into effect October of that year, with compulsory CE marking expected at the same time. **CE marking will require calculations to the Eurocodes.** From this date all light gauge steel suppliers will need to have their systems CE marked in accordance with EN 1090-1, ETAG 023 or ETAG 025. These documents are publicly available, but feel to contact the practice or SCI (details over the page) if you are having problems locating them. The Technical Manual is only small



part of the assessment process (around ten percent), the whole process can be thought of as a combination of the most useful sections of ISO 9000, 1400 and a warranty system such as BRE or NHBC with the added bonus of **being legally required from 2013.**

Previously Stephen Napper Associates Ltd has written Stage 1 NHBC System Manuals and manuals and calculations to support CE marking. The practice has designed buildings up to five storeys with worked examples up to, and including eleven stories.

Stephen Napper Associates offers full design packages including all services from foundation design to ridge beam, with project management, draughting and quantity surveying, back to simple stud or beam design. **All designs can be carried out to the latest Eurocodes or British Standards,** and include for seismic design when required.



The practice offers efficient designs that increase the available spans from floor joists by taking account of the composite action of the joist and finishes as well as improved racking and building stability based upon the latest research as published in “The Structural Engineer” – the journal of the Institution of Structural Engineers.



Stephen Napper  
Associates  
Limited

Stephen Napper Associates  
83 Fairways Avenue  
Harrogate  
North Yorkshire  
UK  
HG2 7EN  
+441423 889464  
[steve@mmcengineer.com](mailto:steve@mmcengineer.com)  
[www.mmcengineer.com](http://www.mmcengineer.com)



Steel Knowledge

Silwood Park  
Ascot  
Berks  
UK  
SL5 7QN  
tel: 01344 636525  
fax: 01344 636570  
[A.Way@steel-sci.com](mailto:A.Way@steel-sci.com)  
[www.steel-sci.org](http://www.steel-sci.org)